

* WHEN CONSTRUCTING MULTIPLE POST INSTALLATIONS, THE POST SPACING SHALL BE A MINIMUM OF 7'-4" CENTER TO CENTER OF THE POSTS UNLESS USED BEHIND GUARDRAIL A DISTANCE \geq THE DEFLECTION DISTANCE

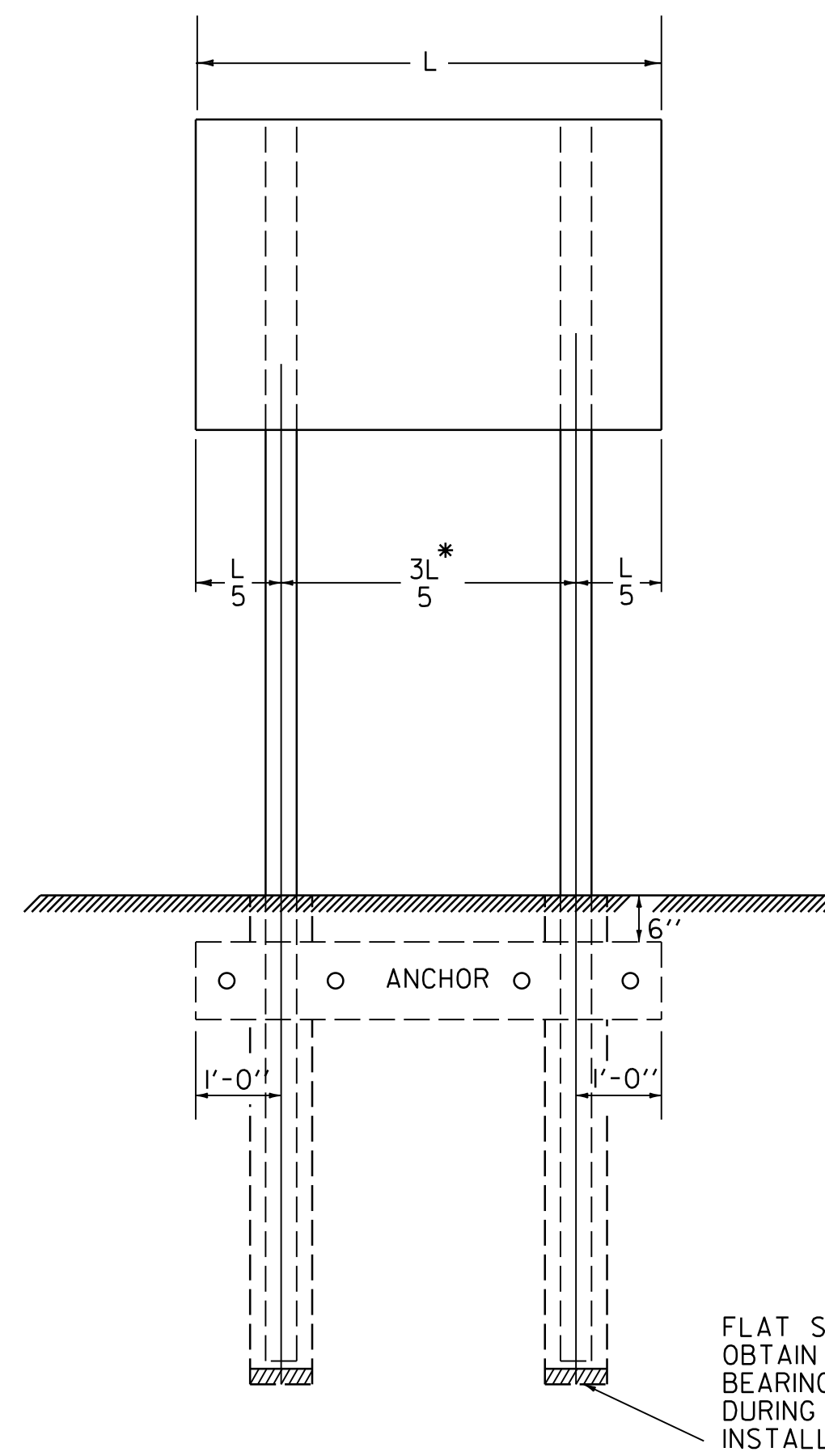

IN AREAS WHERE LEDGE ROCK IS ENCOUNTERED POSTS WILL BE SET AND GROUTED WITH TYPE 4 MORTAR, 24" BELOW THE TOP SURFACE OF THE SOLID ROCK UNLESS THE POSTS PENETRATE THE GROUND A MIN. 4'.

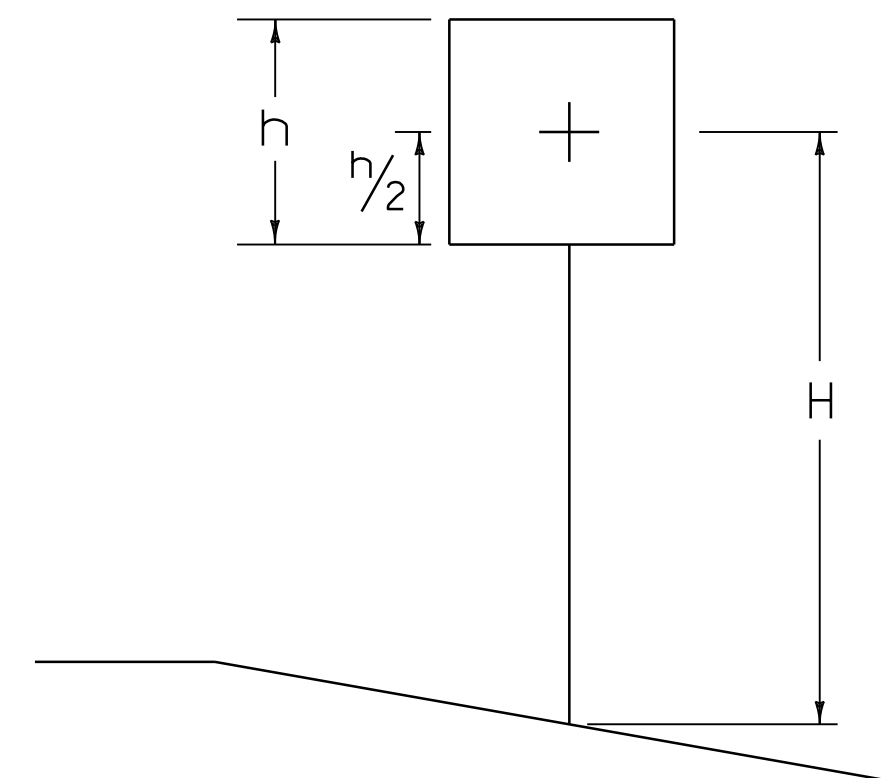
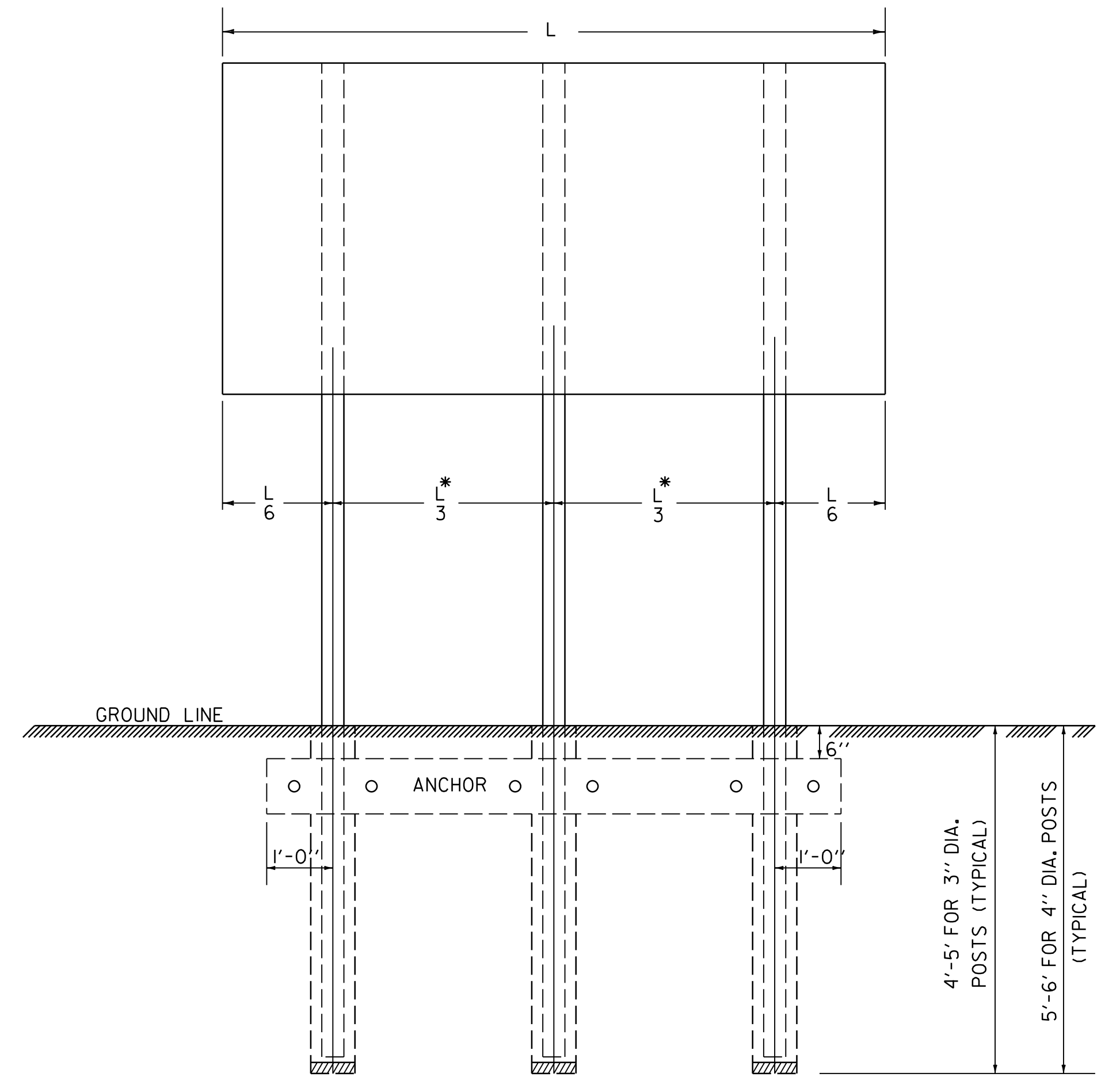

POST SELECTION CHART		
SIGN AREA (FT. ²) x H(FT.) \leq SV (SELECTION VALUE)		
POST SIZE	Sv (FT. ³)	DESIGN CRITERIA
3" DIA.	156	WIND VELOCITY = 60 MPH (10 YEAR MEAN RECURRENCE INTERVAL)
4" DIA. *	286	WIND PRESSURE = 14 PSF
4" DIA. (MOD) *	282	ALUMINUM Fy = 24,000 PSI ALLOWABLE STRESS = 1,4 (24,000) PSI

* TWO POST INSTALLATIONS - USE ONLY BEHIND GUARDRAIL AT A DISTANCE \geq THE GUARDRAIL DEFLECTION DISTANCE.

POST WEIGHTS		
POST DIAMETER	WALL THICKNESS	WEIGHT PER FT.
3" ROUND	1/8"	1.3 LBS
4" ROUND	1/8"	1.7 LBS
4" ROUND (MOD.)	1/8"	1.7 LBS

NOTES

ANCHORS USE TWO (2) PIECES OF 2" x 12" ROUGH PLANK. PLANKS, UNLESS OTHERWISE NOTED, SHALL CONFORM TO "STANDARD SPECIFICATIONS FOR CONSTRUCTION" SECTION 728.01.

ERECTION LOCKNUTS ON 3/8" #16 ALUMINUM POST BOLT CLIPS SHALL BE TORQUED TO 225 INCH POUNDS USING DRY, CLEAN, UNLUBRICATED THREADS. WHERE ALUMINUM SURFACES ARE TO BE PLACED IN CONTACT WITH WOOD, THEY SHALL BE GIVEN A THICK COAT OF AN ALKALI-RESISTANT BITUMINOUS PAINT MEETING THE REQUIREMENTS OF MILITARY SPECIFICATION MIL-P-6883, WHICH SHALL BE DRY BEFORE INSTALLATION.

THE HOLE SHALL BE CAREFULLY DUG AND THE POST SET TO THE DEPTH SPECIFIED ABOVE. POST SHALL NOT BE DRIVEN. THE BACKFILL MATERIAL SHALL CONFORM TO THE REQUIREMENTS OF APPROVED GRAVEL OR SHALL BE A MATERIAL APPROVED BY THE ENGINEER. COMPACTION OF THE BACKFILL WILL BE PERFORMED AS DIRECTED BY THE ENGINEER.

REV.	DATE	DESCRIPTION
0	SEP. 10, 1987	ORIGINAL APPROVAL
3	MAR. 11, 1996	REVISED POST SELECTION CHART
4	MAY 20, 1999	ORIGINAL LOST NEEDED NEW SIGNATURE
3	JUN. 25, 2024	MINOR REVISIONS, BORDER UPDATE
OTHER STANDARDS REQUIRED:		

TUBULAR ALUMINUM SIGN POST

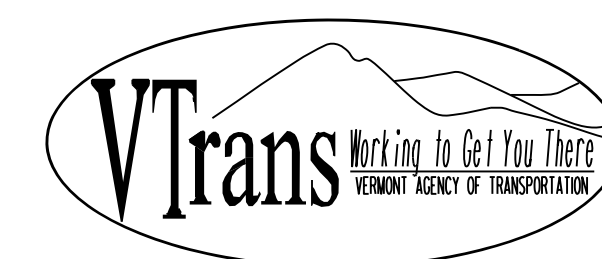

STANDARD
E-162